



701 GULLO AVE. ELK GROVE, IL 60007
PHONE 1-847-640-7002 FAX 1-847-640-7008
EMAIL sales@triteqlock.com

Retro-fit Installation

A Video CD of these instructions (MPEG) is also available (Part # retrocd ins) from TriTeq.

PN 10622-00-00

Tool list: 3/8" drill, 3/16" & 5/16" drill bits, Pliers, #2 Phillips Screwdriver, End nippers, Allen wrench set, Vise grip, 7/16 (Vendo) or 3/8 (Dixie) socket and ratchet, 3/8" Breaker bar, Socket tool (TriTeq P/N CUS717), Alignment tool (TriTeq P/N ALIGNDF717S), Torque driver bits (TriTeq P/N T25BIT), Step-drill for T-handle (TriTeq P/N SD717).



Step One: Remove the old T handle and shaft

Tools: Medium flat head screw driver

Remove the E ring holding the shaft and pull out through the front.

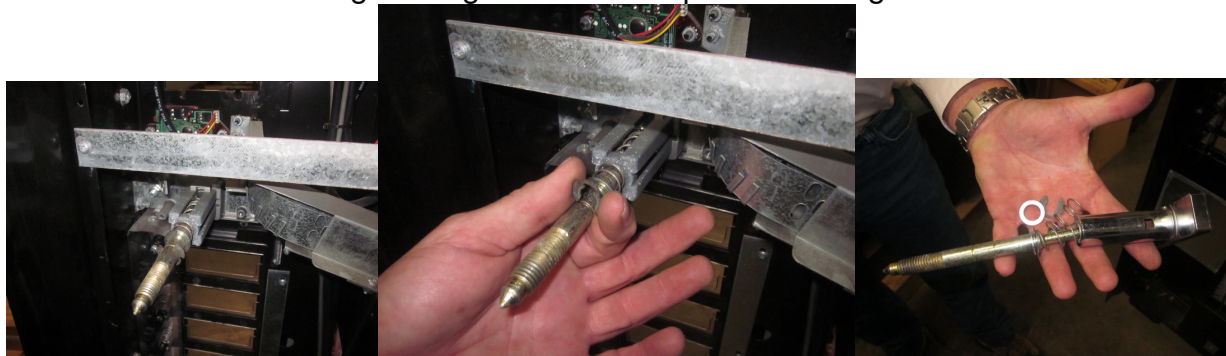

Step Two: Prepare the old T handle housing for the lock

Tools: drill, step up drill bit, side cutters and break off socket tool.

Cover the coin mech. with a towel. Using the step drill, drill into the back of the T handle housing until the drill can not go in any further. Use the break off socket tool to remove the 4 legs left of the T-handle housing. Use the end nippers as required finish removing the ends of the four legs.

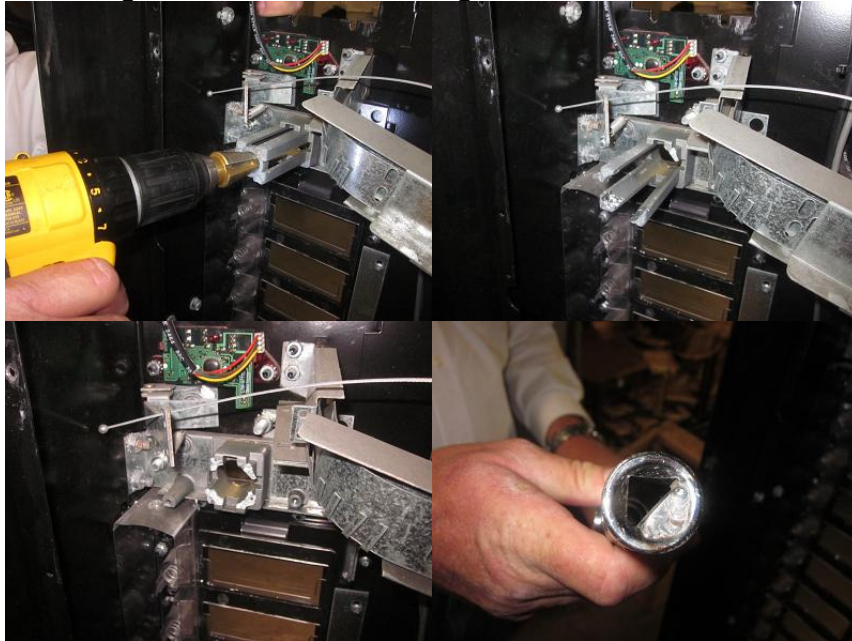

Step Three: Locate any coin chutes or coin return levers that may hit the mechanism

Tools: Side cutters.

Remove any plastic corners from coin chute or bend the lever for the coin return mech. as required. (Vendo Only)

Step Four: Align the lock

Tools: Vise Grip, Alignment tool and drill fixture and 7/32 drill bit

Attach alignment tool to drill fixture and slide alignment tool through t-handle housing from back to front and tighten. If needed to keep a left to right and up and down alignment use a small vice grip on the right hand side.

Vendo 511s drill the top and bottom holes on the drill fixtures left hand side and 2 enlarged holes on the fixture on the right.

Vendo 540s drill the 3 middle enlarged holes on left side and 2 on right.

Dixie 501s drill the 3 middle on left and 2 on right..



Step Four A: Rotate the motor assembly (see Fig. 1) skip this step if there is no interference in step four

Tools Phillips screwdriver

Remove two screws and rotate motor to new position. Align screw holes with new position making sure the gears mesh properly. Reinstall screws tightening securely. Do not over tighten.

Step Five: Mount the lock.

Tools Drill, T-25 torque bits, small vise grips and drill

Align lock with holes drill into door frame and lock in place with vise grips.

Place support brackets on the back side of door frame and align with holes in the lock and door frame and attach with the T-25 torque screws .

Vendo 511s all 7 screws

Vendo 540s and Dixies 5 screws.

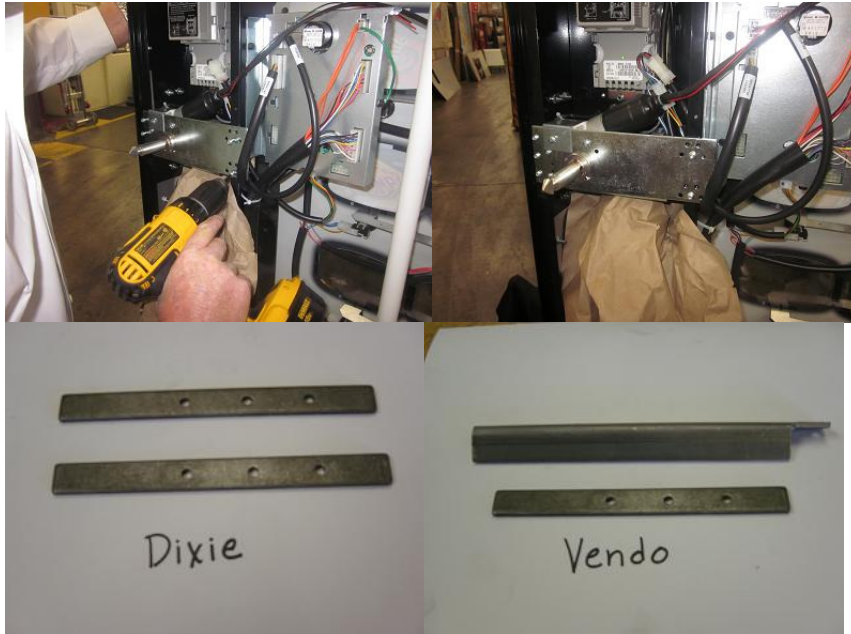

Step Six: remove the old nut receptacle.

Tools: 7/16 socket wrench

Remove the three (Dixie) or four (Vendo mounting bolts holding the nut receptacle on.



Step Seven: Mount the new receptacle

Tools: 7/16 socket wrench

Mount the new receptacle and align the receptacle where the centerline of the old one was. (Hold the old one above the new one and compare the centerline.)



Step Eight: Install the CPU

Wipe off the surface to mount the CPU next to the bill validator. Remove the adhesive backing on the Velcro and attach to the wall.



Step Nine: Route the wires

Tools: Phillips screwdriver

Route the wires under product chute and plug them into the CPU.

Remove the vend motor cover. Route the wires behind the motor cover and along the existing harness. Route wires up to CPU. Plug the CPU in. Plug the lock assembly into the CPU. Route the battery back up wire to the product chute.



Step Ten: Install the battery back up plug

Tools: 5/16 drill bit, Drill, Pliers

Drill a 5/16 hole in the product chute. Attach the back up plug into this hole and tighten with pliers.

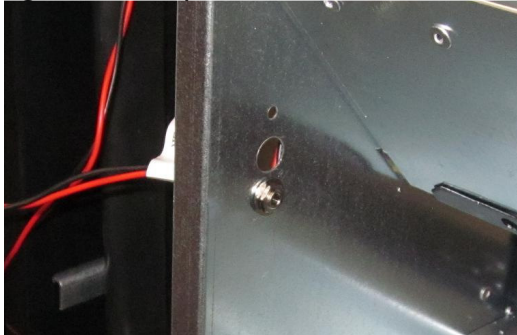

Step Eleven: Feed Infrared sensor wire into T-handle hole

Feed sensor wires into T-handle hole and plug sensor wire into CPU. Do not plug T-blocker in T-Handle hole, let it hang out until you complete tasks 12-14.



Step Twelve: Attach the power

Tools: Pliers

Disconnect 24VDC power cable between the Coin Changer and the DBV. Locate TriTeq power cable with two JST connectors wired in parallel. Insert Coin Changer and DBV connector into TriTeq power harness cable. Now all three devices (Coin Changer, DBV, TriTeq CPU) will have power.

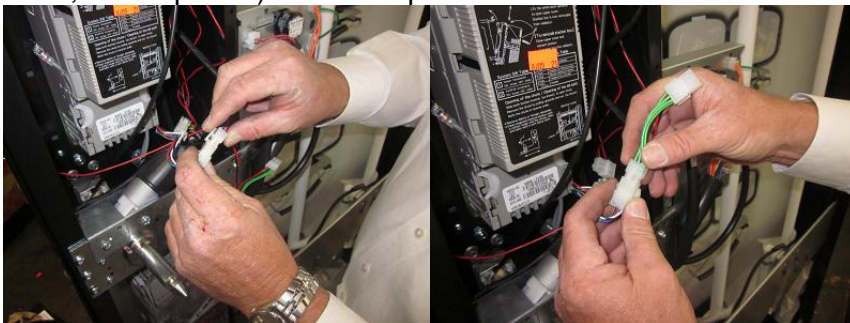

Step Thirteen: Test the lock

Tools: None

First see that the bayonet passes through the insulation door without pushing the bayonet backwards. Next press the program button on the CPU. The LED should come ON. Place a P1 key in front of the #1 button (Sensor) and press the Key fob button. Observe the LED flashing. With the door open, push the flap on the receptacle and hold it until the lock "locks". Use the P1 and open the door. Now close the door and open it with the P1 Key Fob.

Step Fourteen: Adjust the door tension

Tools: Allen wrench

Close the door. Using an appropriate Allen wrench reach into the old T handle housing from the front and adjust the allen screw inside the mechanism. Test door tightness and adjust as necessary.



Step Fifteen: Install the T handle blocker

Tools: None

Install the T handle blocker. From the inside insert the tapered pin into the hole in the shaft of the T-handle blocker and push down until seated.

